

QuarttoLino - Babyeinsatz

Gebrauchs- und Montageanleitung

Installation and operating instructions for baby insert

- **WICHTIG:**
- Sorgfältig lesen und für späteres Nachlesen aufbewahren
- **IMPORTANT:**
- Read carefully and keep for future reference

QuarttoLino e.U.
Kremstalstraße 96
4050 Traun, Austria, EU
www.quarttolino.com
office@quarttolino.com

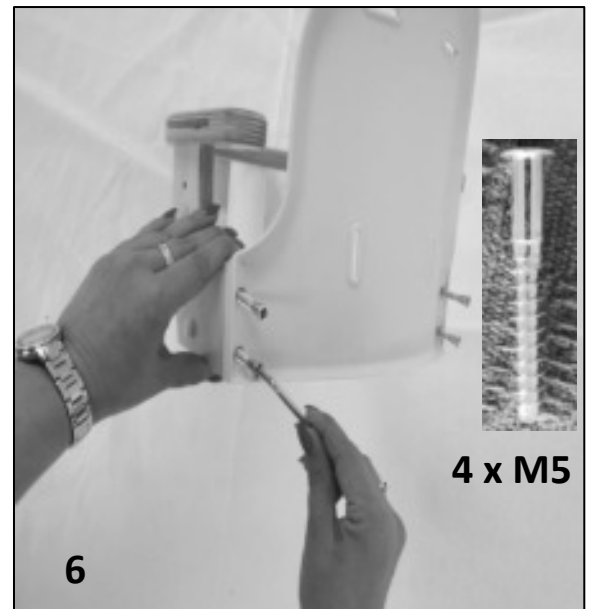
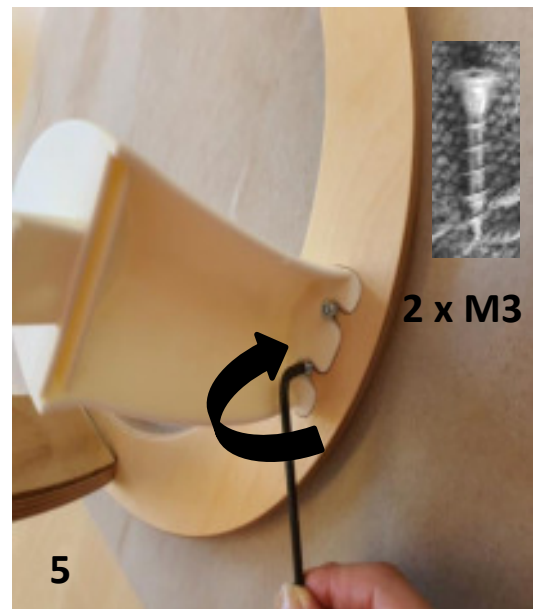
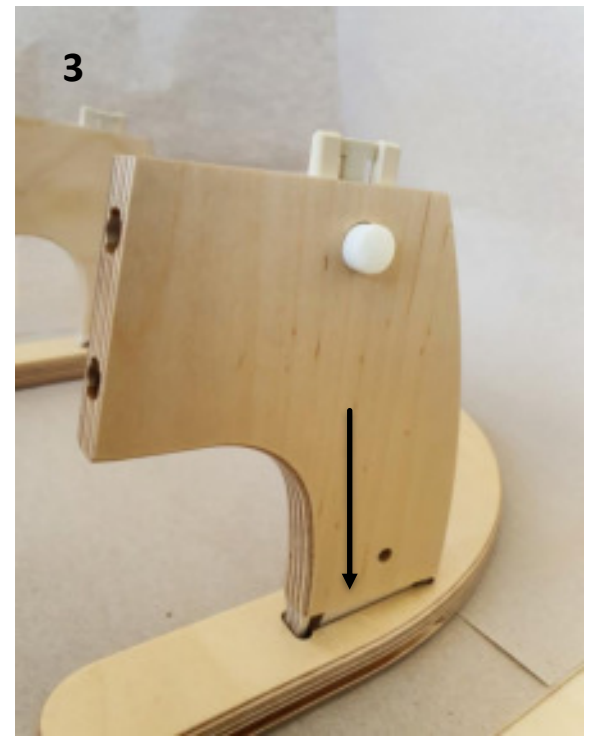
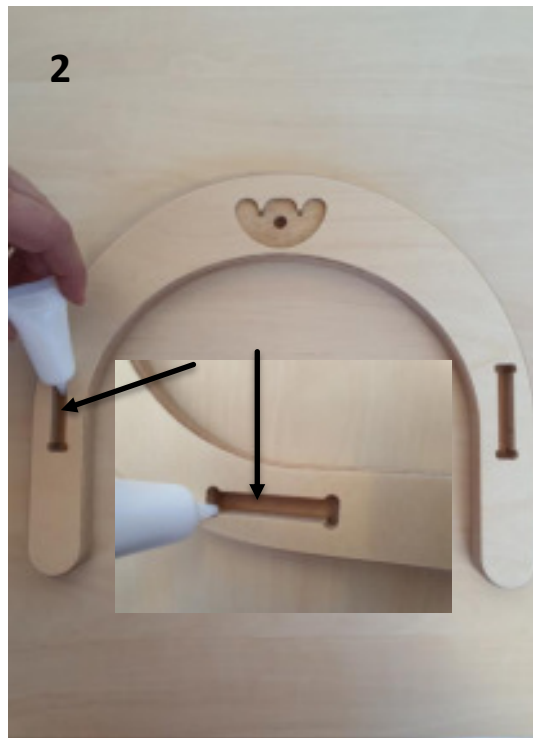



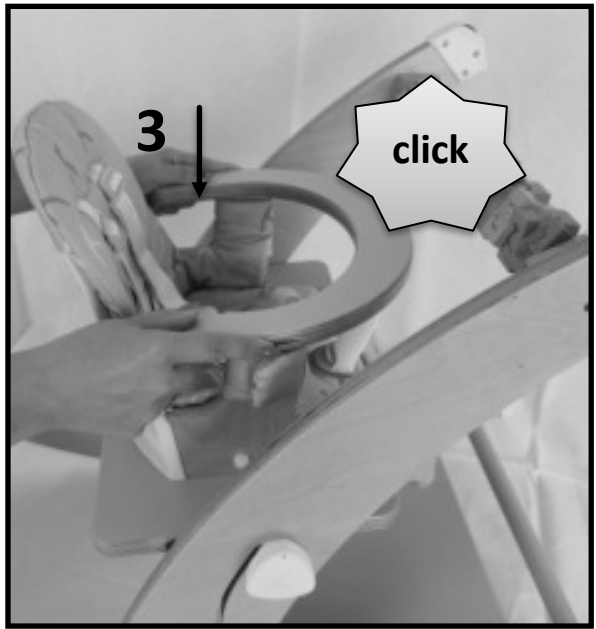
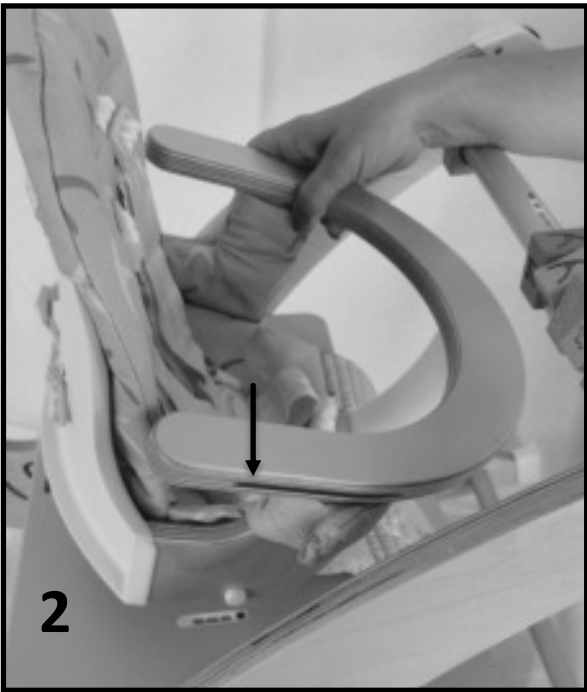
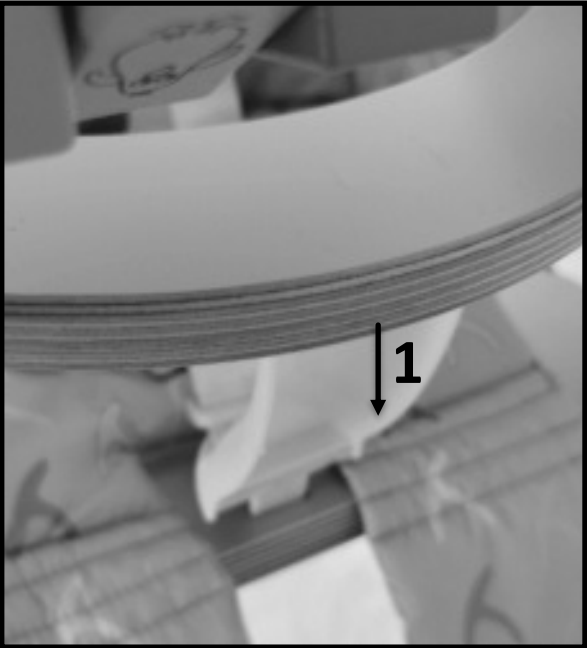

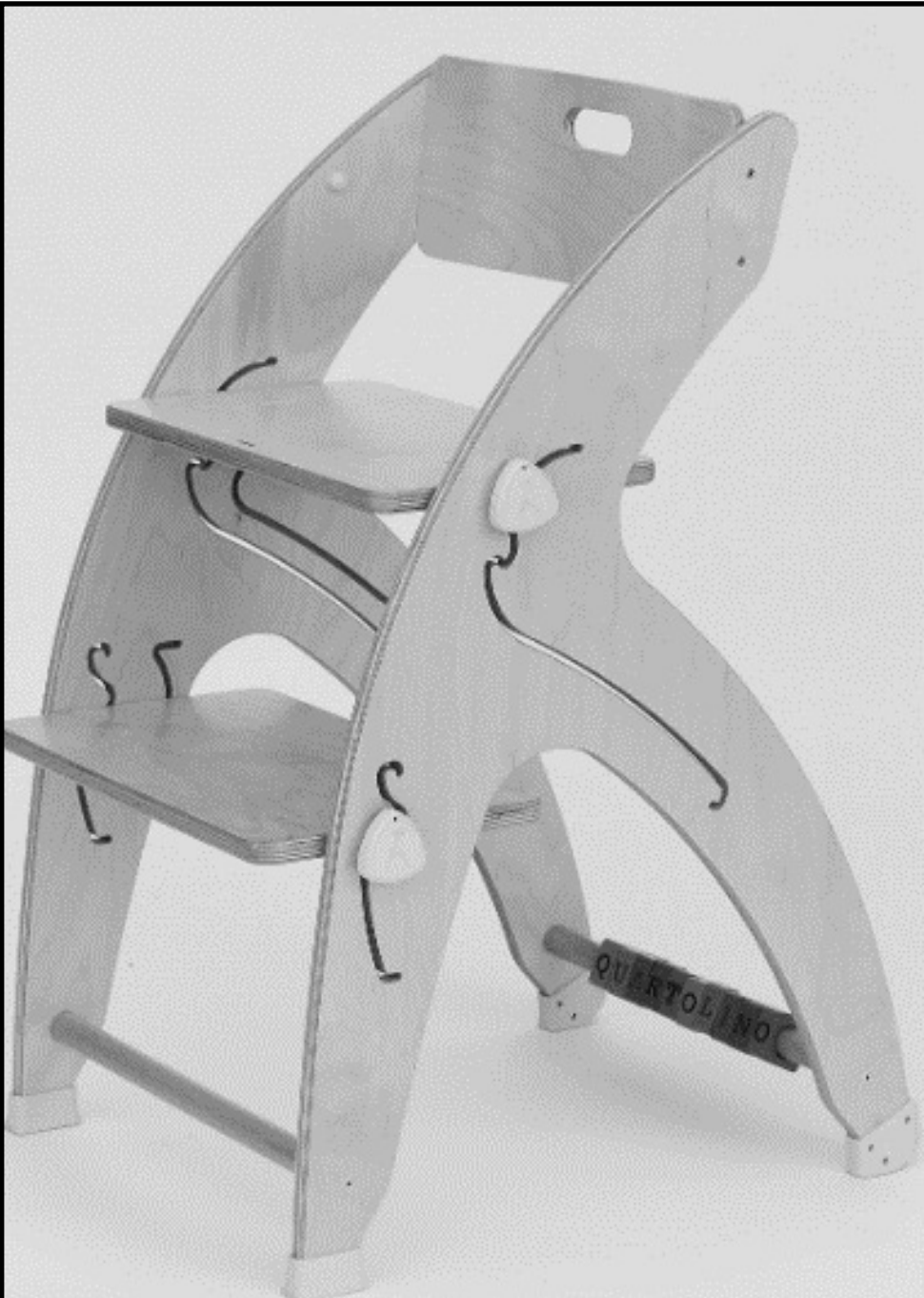

Warnhinweis! Setzen- und entnehmen Sie niemals die Spielzeuge, während sich Ihr Kind auf dem Stuhl befindet!!!

Warning! Never put and remove the toys while your child is on the chair !!!

Quarttolino e.U.

Kremstalstraße 96

4050 Traun, Austria

Tel.: + 43 676 6740124

Email: office@quarttolino.com

Web.: <https://quarttolino.com>

WARNUNG:

- Das Kind niemals unbeaufsichtigt lassen.
- Immer das Rückhaltesystem verwenden.
- Sturzgefährdung: Das Kind von Klettern auf dem Produkt abhalten.
- Das Produkt nicht benutzen, falls nicht alle Bauteile einwandfrei angebracht und eingestellt sind.
- Auf das Risiko durch offenes Feuer und andere Starke Wärmequellen in unmittelbarer Nähe des Produktes achten.
- Es besät das Risiko, dass das Produkt umkippen könnte, wenn das Kind die Füße gegen einen Tisch oder einen anderen Gegenstand drückt.

**WARNUNG:**

- Benutzen Sie den QuarttoLino Babyeinsatz erst, wenn das Kind selbstständig aufrecht sitzen kann (ab ca. 6 Monaten) bis ca. drei Jahre oder einem Höchstgewicht von 15 kg.
- Lassen Sie das Kind nie unbeaufsichtigt im QuarttoLino Babyeinsatz sitzen.
- Stellen Sie sicher, dass der QuarttoLino Babyeinsatz richtig montiert ist, bevor Sie das Kind hineinsetzen. Man hört ein „Klick“, wenn der Babyeinsatz einrastet.
- Benutzen Sie den QuarttoLino Babyeinsatz nur, wenn alle Bauteile vollständig und einwandfrei sind.
- Benutzen Sie den QuarttoLino nicht, wenn irgendein Teil gebrochen oder gerissen ist oder fehlt.
- Babyeinsatz immer mit Baby Gurt verwenden. Nur original QuarttoLino Baby Gurt verwenden.
- Achten Sie auf das Risiko durch offenes Feuer und andere starke Wärmequellen in unmittelbarer Nähe des QuarttoLino.

WARNING:

- **Never leave the child unattended.**
- **Always use the restraint system.**
- **Fall hazard: Keep the child from climbing on the product.**
- **Do not use the product unless all components are properly attached and adjusted.**
- **Beware of the risk of open fire and other strong heat sources in the immediate vicinity of the product.**
- **There is a risk that the product could tip over if the child presses their feet against a table or other object.**

WARNING:

- **Only use the QuarttoLino baby insert when the child can sit upright independently (from approx. 6 months) up to approx. Three years or a maximum weight of 15 kg.**
- **Never let the child sit unsupervised in the QuarttoLino baby insert.**
- **Make sure that the QuarttoLino baby insert is correctly installed before you put the child in it. You hear a “click” when the baby insert snaps into place.**
- **Only use the QuarttoLino baby insert when all components are complete and in perfect condition.**
- **Do not use the QuarttoLino if any part is broken, torn or missing.**
- **Always use the baby insert with a baby belt. Use only original QuarttoLino baby harness.**
- **Be aware of the risk of open fire and other strong heat sources in the immediate vicinity of the QuarttoLino.**



Warning

- Never leave the child unattended in the QuarttoLino.
- Risk of falling: Do not let the child climb around on the QuarttoLino.
- Danger of tipping over: Make sure that the child sitting in the chair does not push his feet off a table or other object.
- Use the QuarttoLino only in the functions provided (swing, children's table with armchair, small stairs or large, low armchair) and only if these are set correctly.
- Only use the QuarttoLino when the child can sit upright alone.
- In combination with the QuarttoLino baby insert, the QuarttoLino is intended for children who can sit independently up to three years or a maximum weight of 15 kg.
- Always use the baby insert with a baby belt. Use only original QuarttoLino baby harness.
- Only use the QuarttoLino when all components have been correctly attached and adjusted. Pay particular attention to the correct alignment and screwing of the seat and foot plates.
- Do not use the QuarttoLino if any part is broken, torn or missing.
- Always place the QuarttoLino on a stable, level surface.
- Always stay within the child's reach.
- Make sure that the child cannot reach toxic or hot substances, pointed or sharp objects or electrical appliances from the QuarttoLino.
- Any additional dishes not provided by QuarttoLino must comply with EN 13210.
- Be aware of the risk of open fire and other strong heat sources in the immediate vicinity of the QuarttoLino.
- Keep children away when opening, closing and closing the QuarttoLino to avoid injuries.
- Only use accessories and spare parts from QuarttoLino.
- Product information: The QuarttoLino is made from birch plywood. It is glue-free glued and treated with water-based, food-safe varnishes.
- Cleaning recommendation: First wipe the wooden parts with a damp and then with a dry cloth. The use of cleaning agents is not recommended. Wipe the seat cushions or machine wash up to 30 ° C, do not iron, do not tumble dry.